

# Hand Wash sink JUNIOR

## Instruction - Installation

Rev. 0 del 12/05/2015

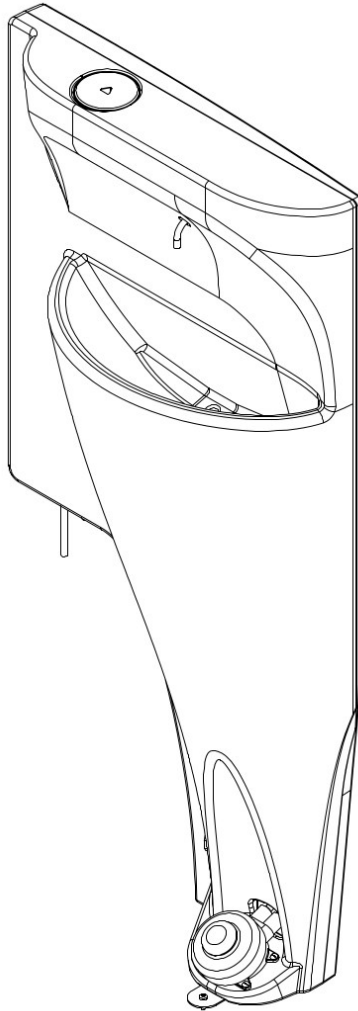

*Armal*®

# Required Tools

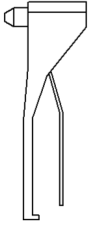

Rivet Gun

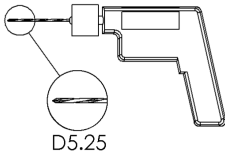

Drill (tip 5.25)

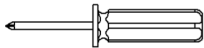

Star screwdriver

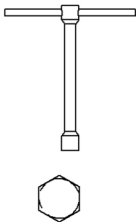

Wrench 17



Armal key

Armal Key

# Items List

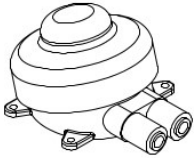

N°1 foot pump



N°1 fixing bracket



N°3 pipe fixing bracket



N°1 gray cap



N°3 Rivet 5x25



N°11 screw M4x15



N°1 self-drilling screw M5



N°1 Inox nozzle



N°1 cap 3/8"



N°2 thread 3/8" - pipe 3/8"



N°2 curve pipe 3/8"



N°1 curve with insert 3/8"



N°1 reduction 1/4" - Ø8



N°1 insert 3/8" - pipe 1/4"



N°2 pipe 3/8" L=5 Cm

N°1 pipe 3/8" L=31 Cm

N°1 pipe 3/8" L=60 Cm



N°1 pipe 1/4" L=97 Cm

# 1° STEP

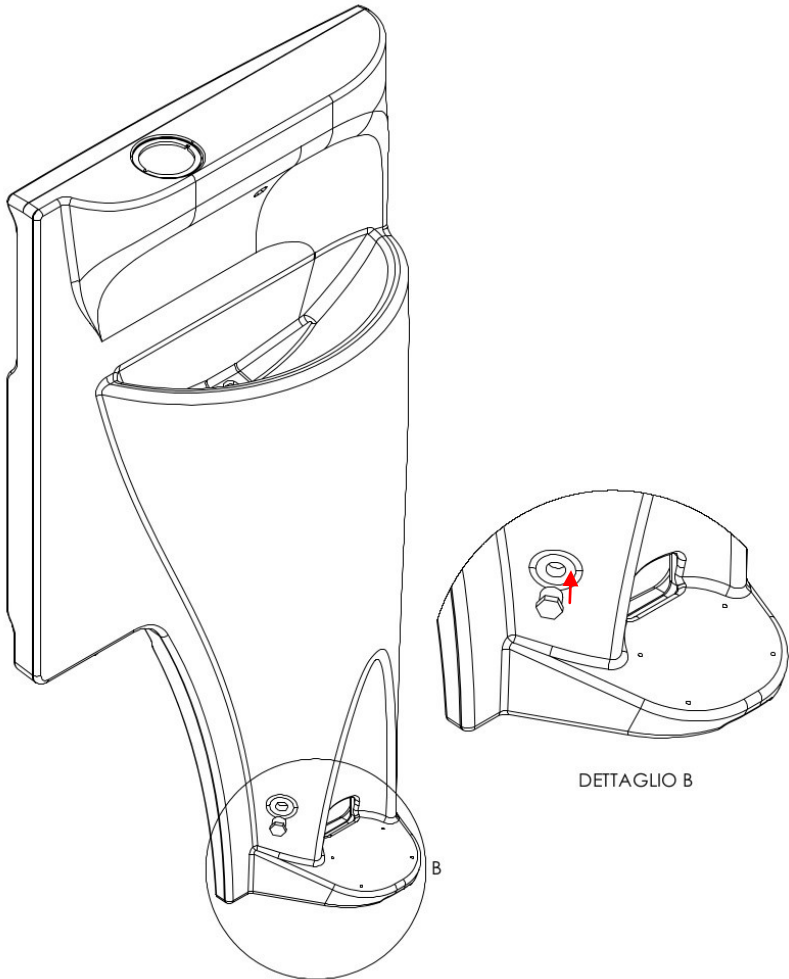

Front side, insert the cap 3/8" in the draining hole  
The use of the teflon to seal the thread is recommended

# 2° STEP

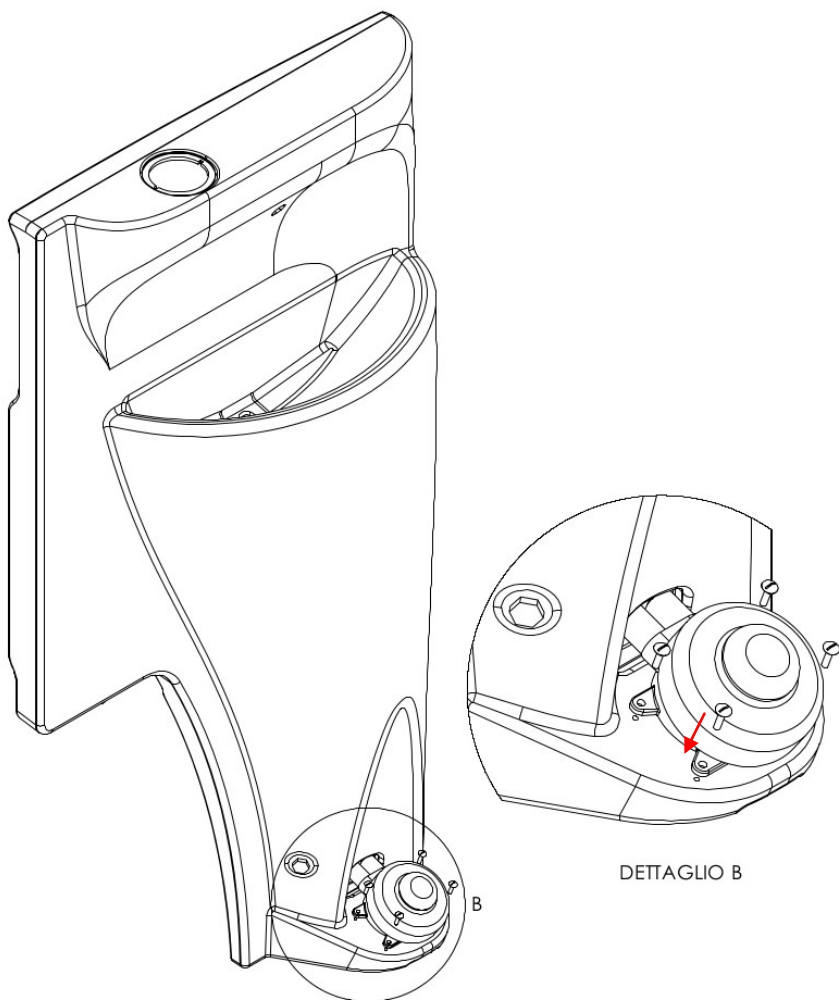

Fix foot pump with 4 screws

# 3° STEP

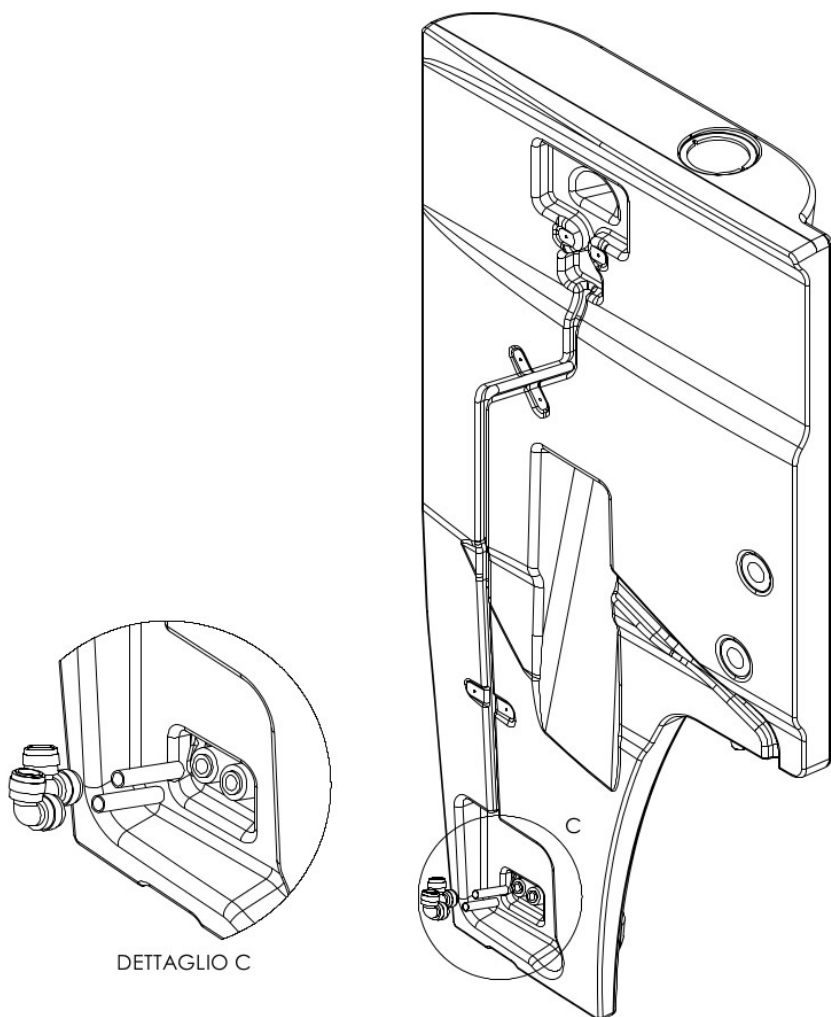

insert the 2 pipes 5cm into foot pump and the 2 curve  
90° in exit.

**WARNING :** push-it fixings required to press well tube for  
have a good result.

# 4° STEP

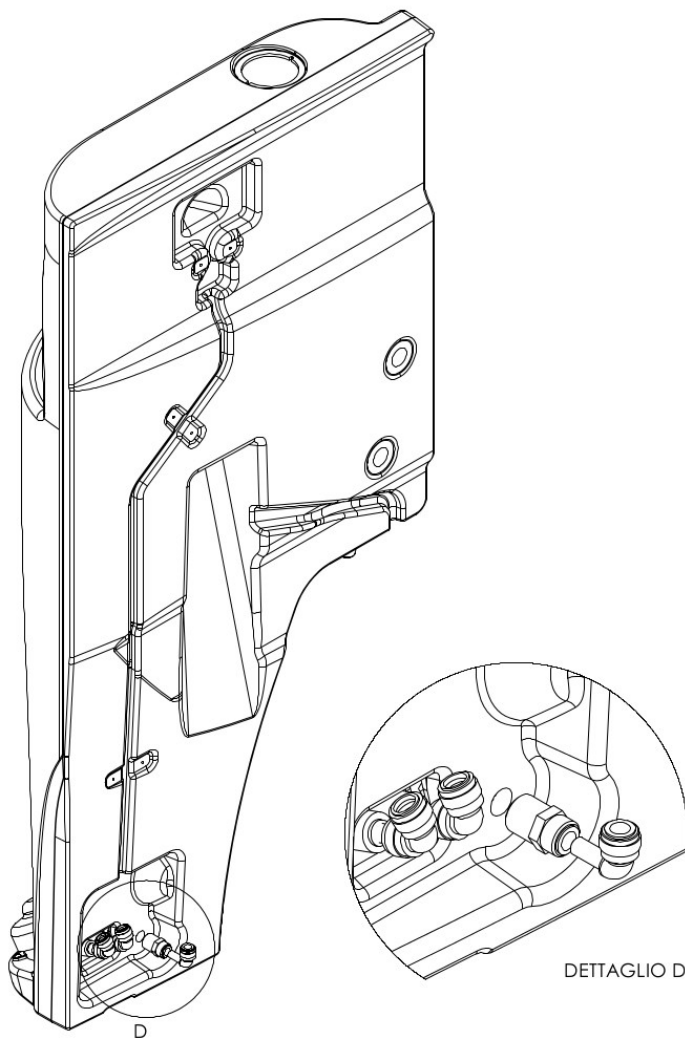

Insert straight coupling 3/8" and relative 90° curve (with stem) in the draft of the tank.

**WARNING :** push-it fixings required to press well tube for have a good result.

# 5° STEP

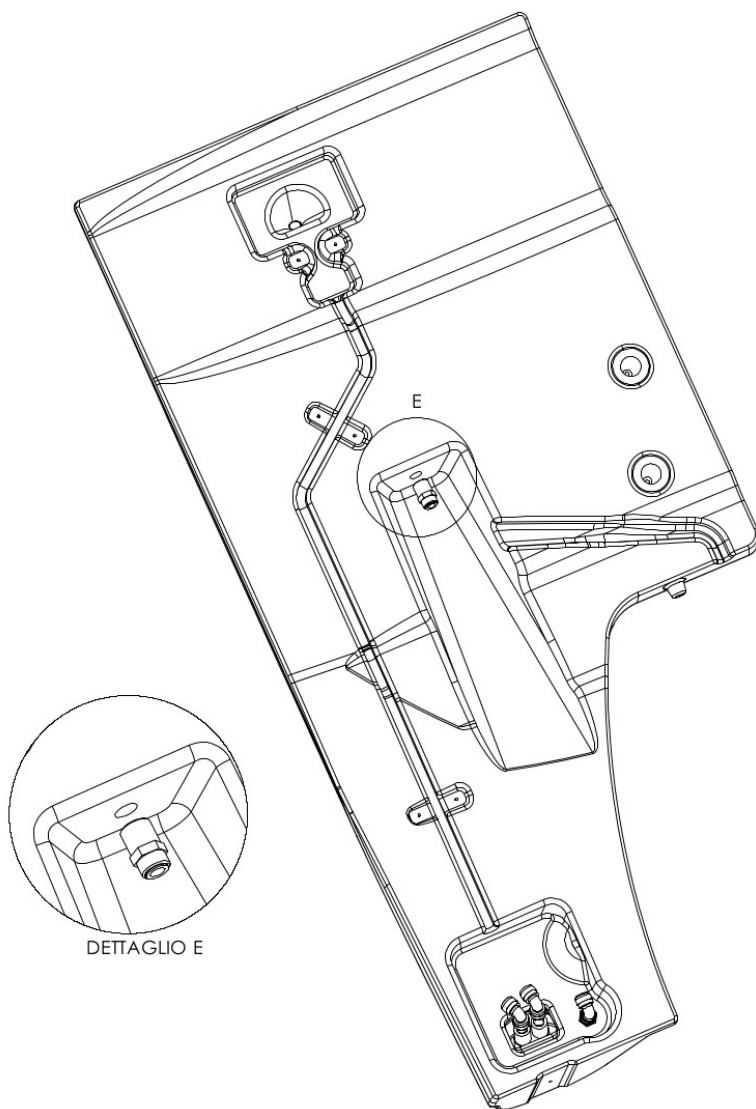

Insert the straight connector 3/8" into the sink drain.  
The use of the teflon to seal the thread is recommended



# 6° STEP

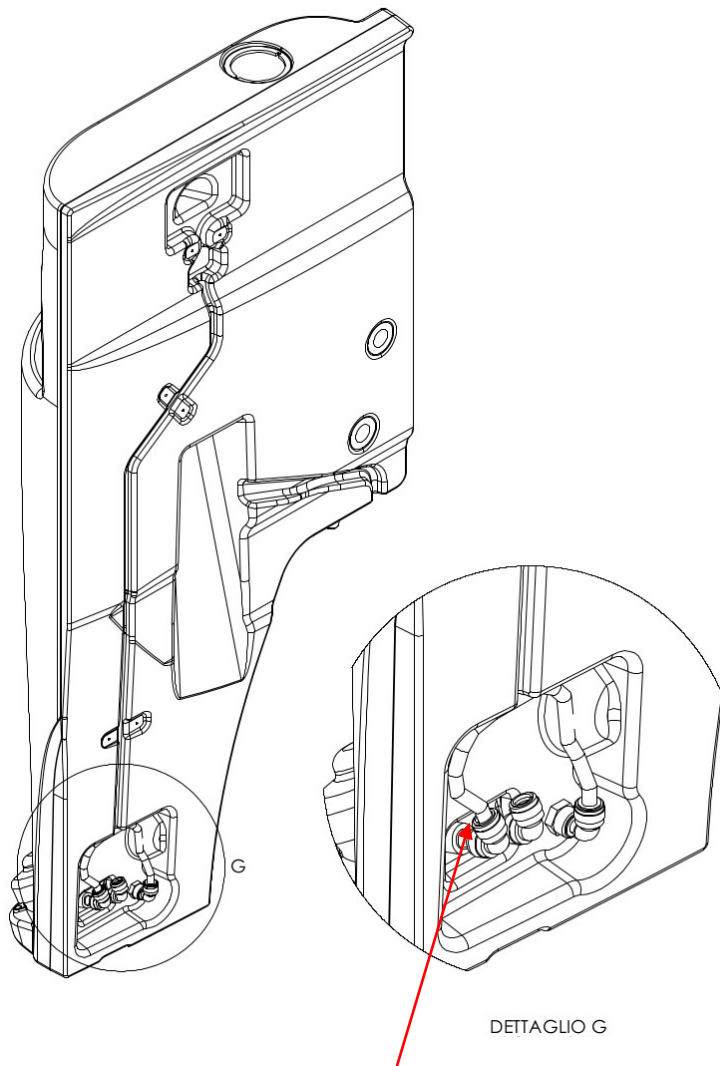

Insert suction pipe (L = 31cm).

The suction of the pump is located on left side (rear view)

**WARNING** : push-it fixings required to press well tube for have a good result.

# 7° STEP

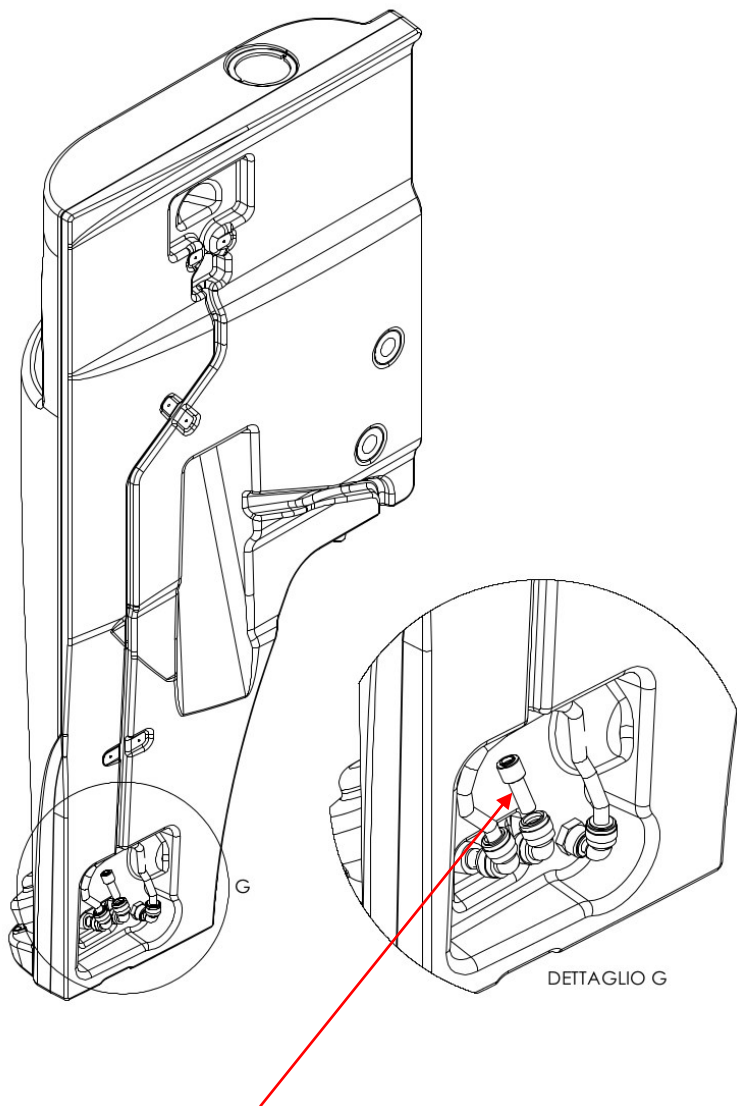

Mount the fitting reduction 1/4" pipe in exit of pump.

**WARNING :** push-it fixings required to press well tube for have a good result.

# 8° STEP

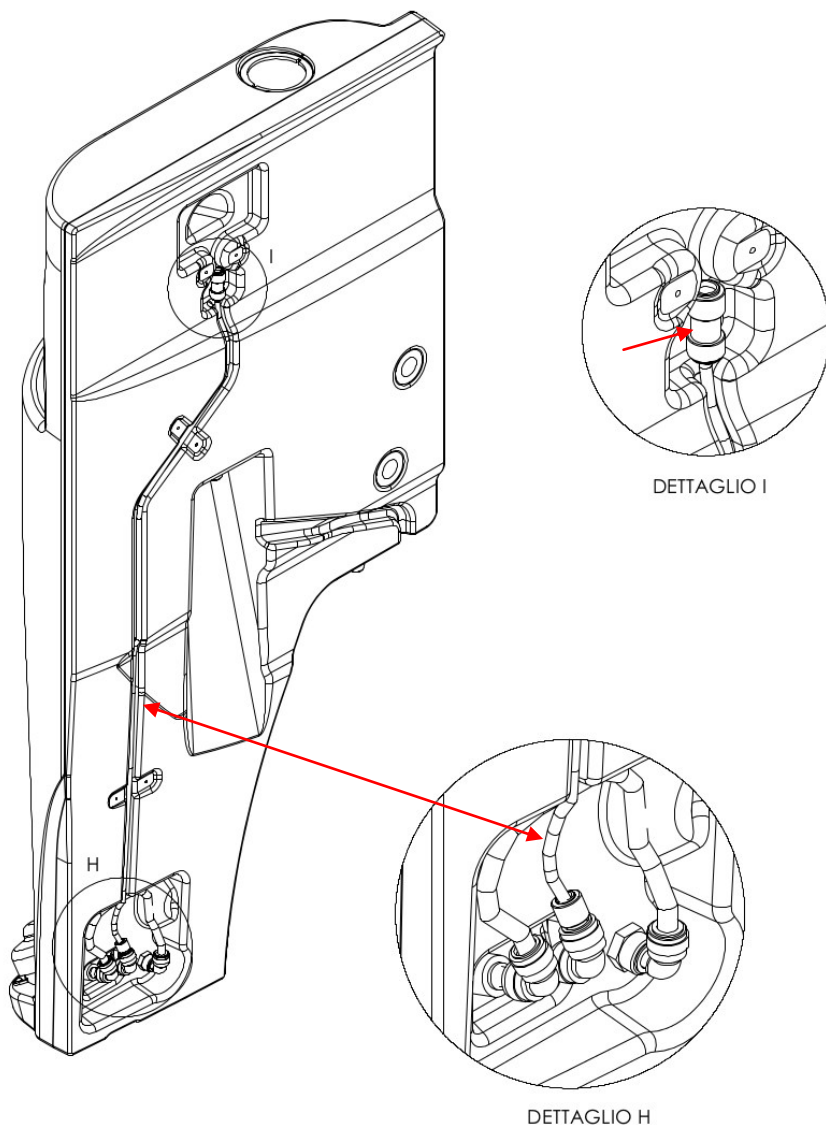

Insert pipe 1/4" and connect reduction 1/4" - Ø8 upside (detail I).

**WARNING** : push-it fixings required to press well tube for have a good result.

# 9° STEP

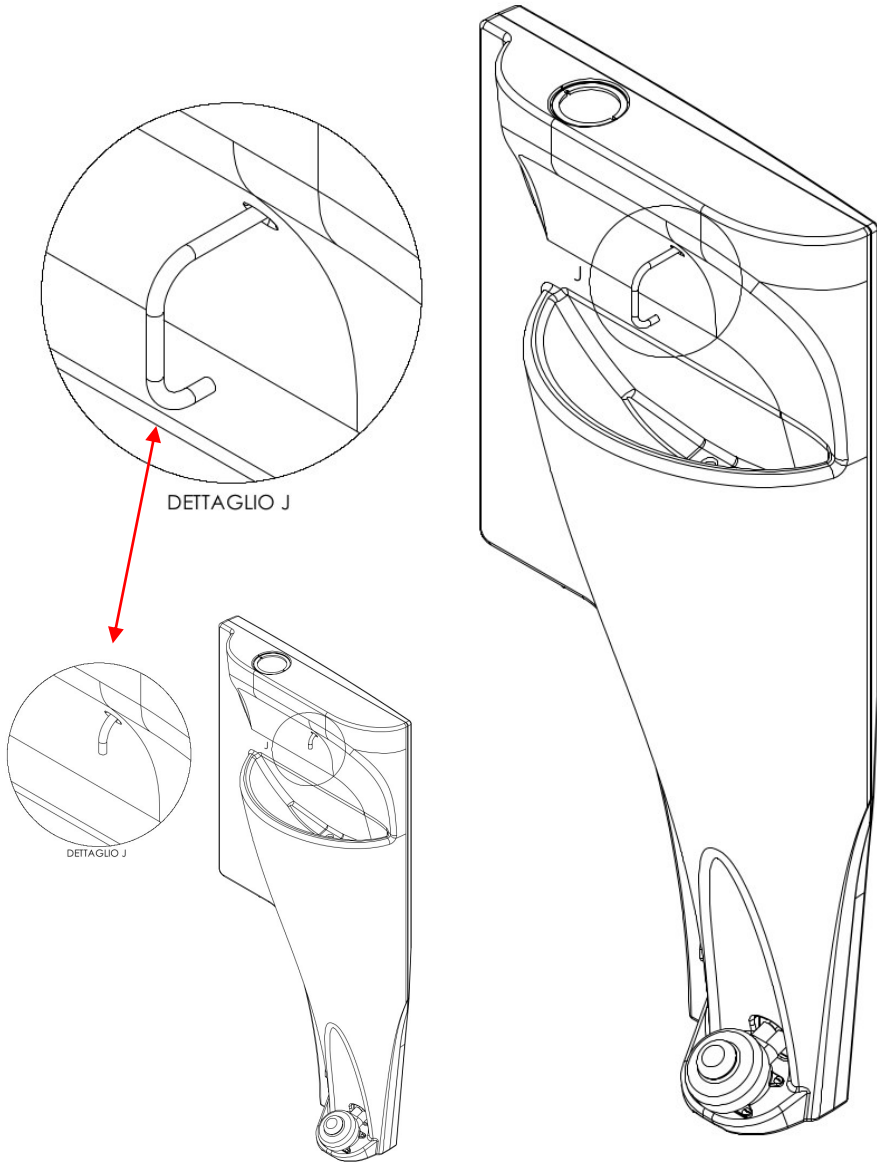

Insert the inox nozzle in the front side of the hand wash sink (see detail J) and rotate it to bring it into correct position.

# 10° STEP

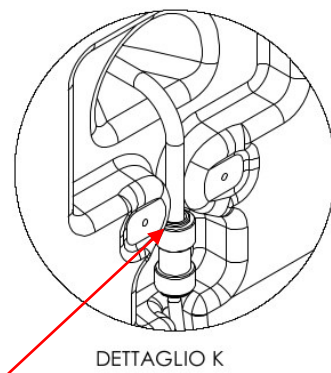
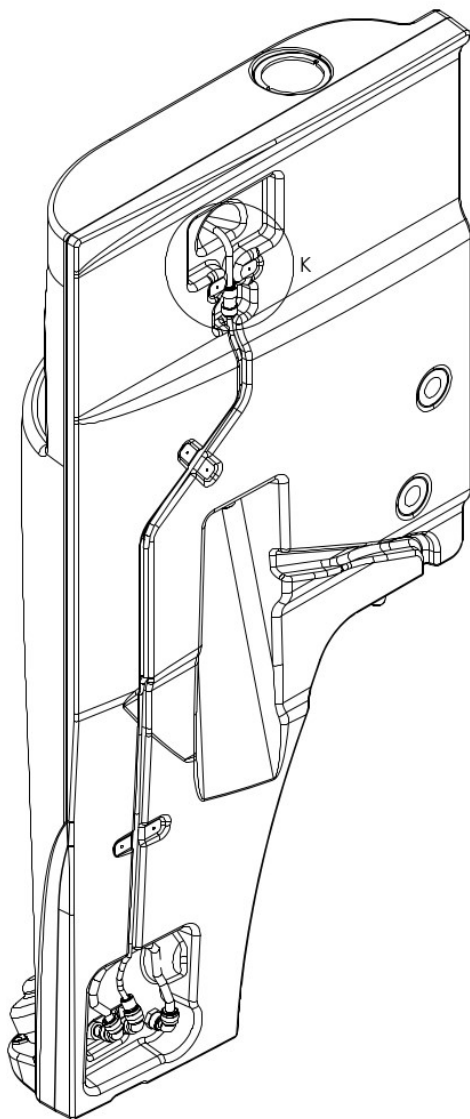

DETTAGLIO K

Insert the inox nozzle into the junction

**WARNING** : push-it fixings required to press well tube  
for have a good result.

# 11° STEP

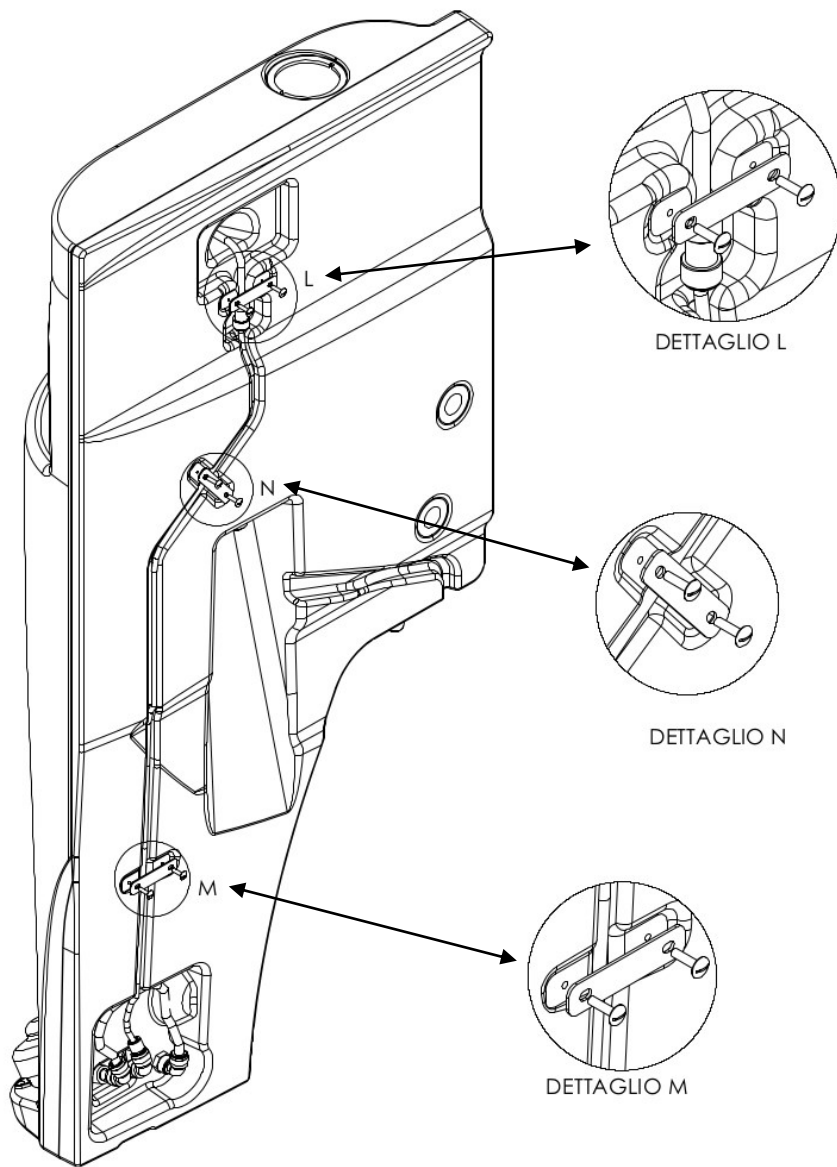

Mount the pipe fixing bracket with screw M4x10

# 12° STEP

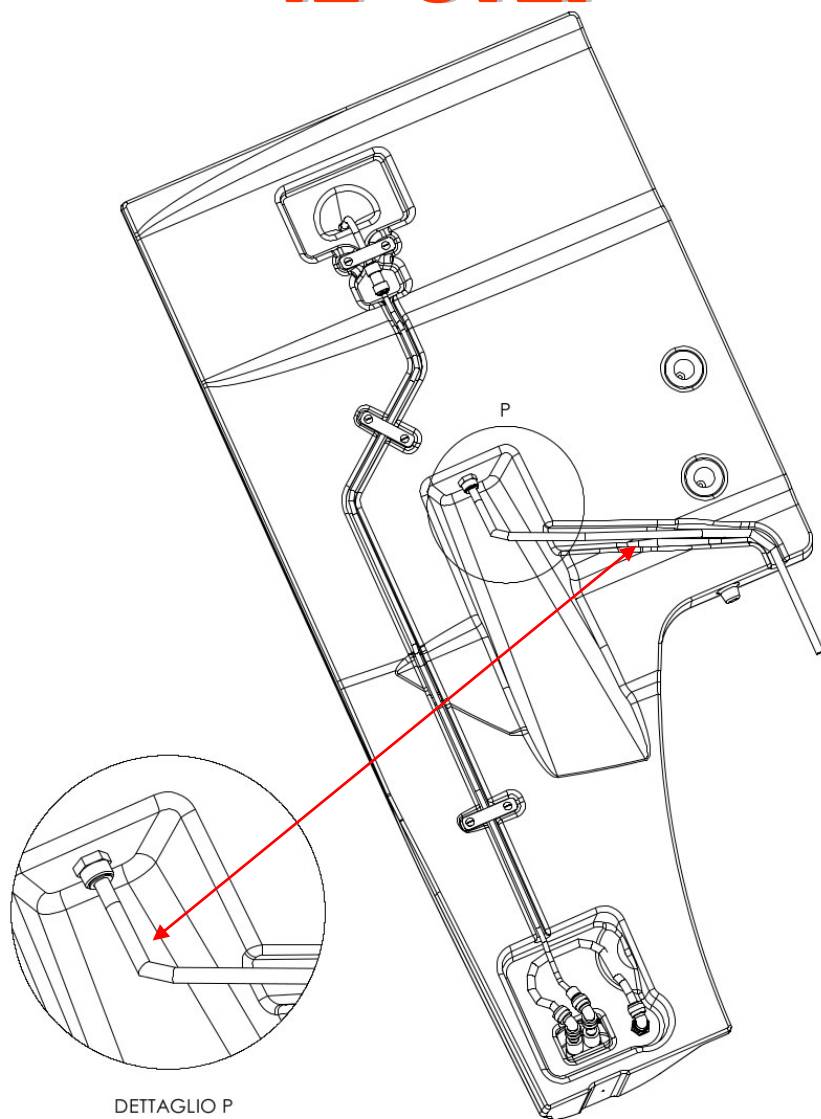

Insert the discharge pipe (L = 60cm)

**WARNING** : push-it fixings required to press well tube  
for have a good result.

# 13° STEP

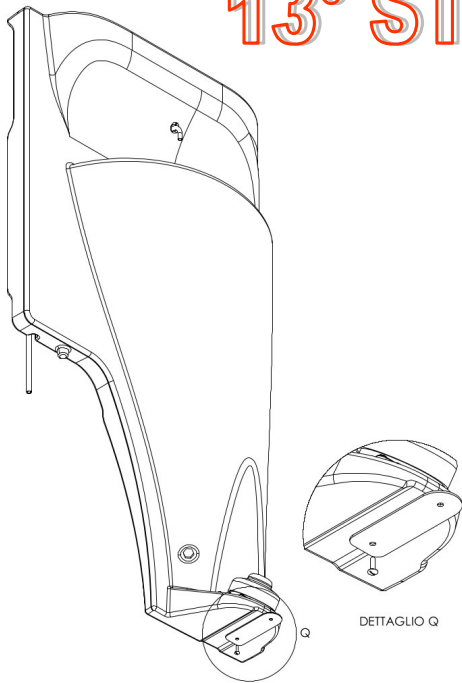

Mount the fixing bracket in the base (screw M4x15).

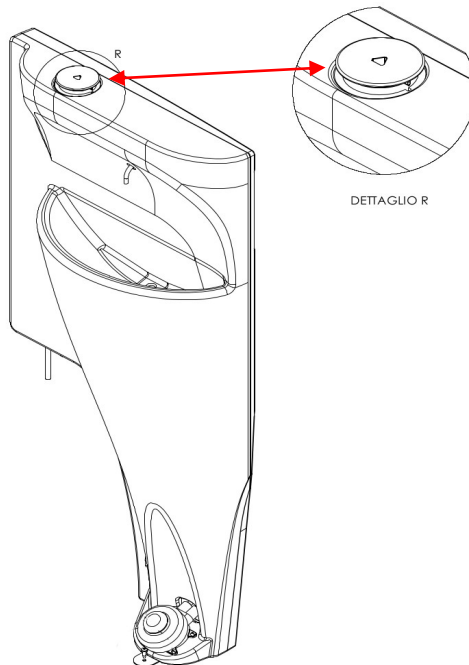

Mount the gray cap.



# Installation 1

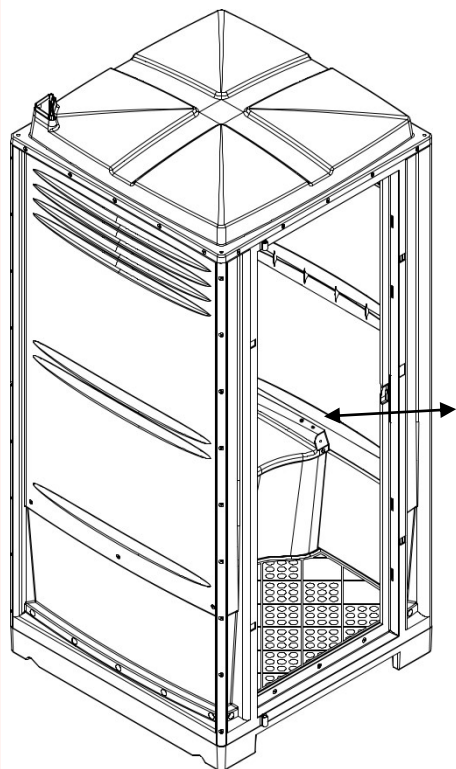

Hole for discharge. Insert here discharge pipe of hand wash sink

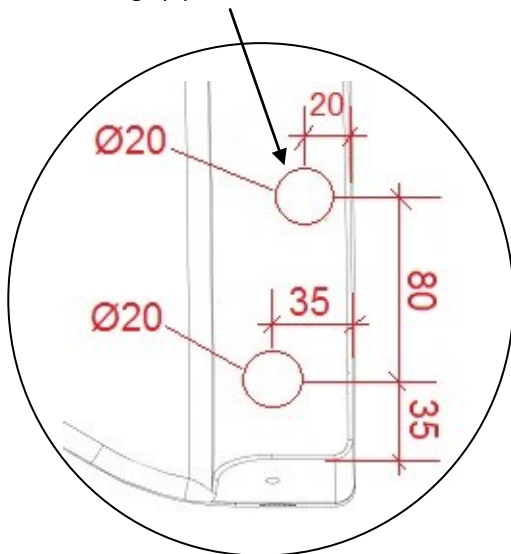

Tank preparation. Drill N° 2 hole  $\text{Ø}20$  at the indicated point. This 2 holes are necessary to insert the centering pin and the discharge pipe of hand wash sink.

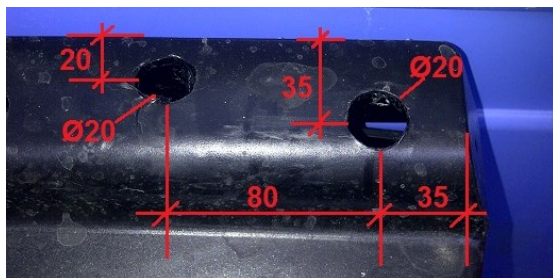

# Installation 2

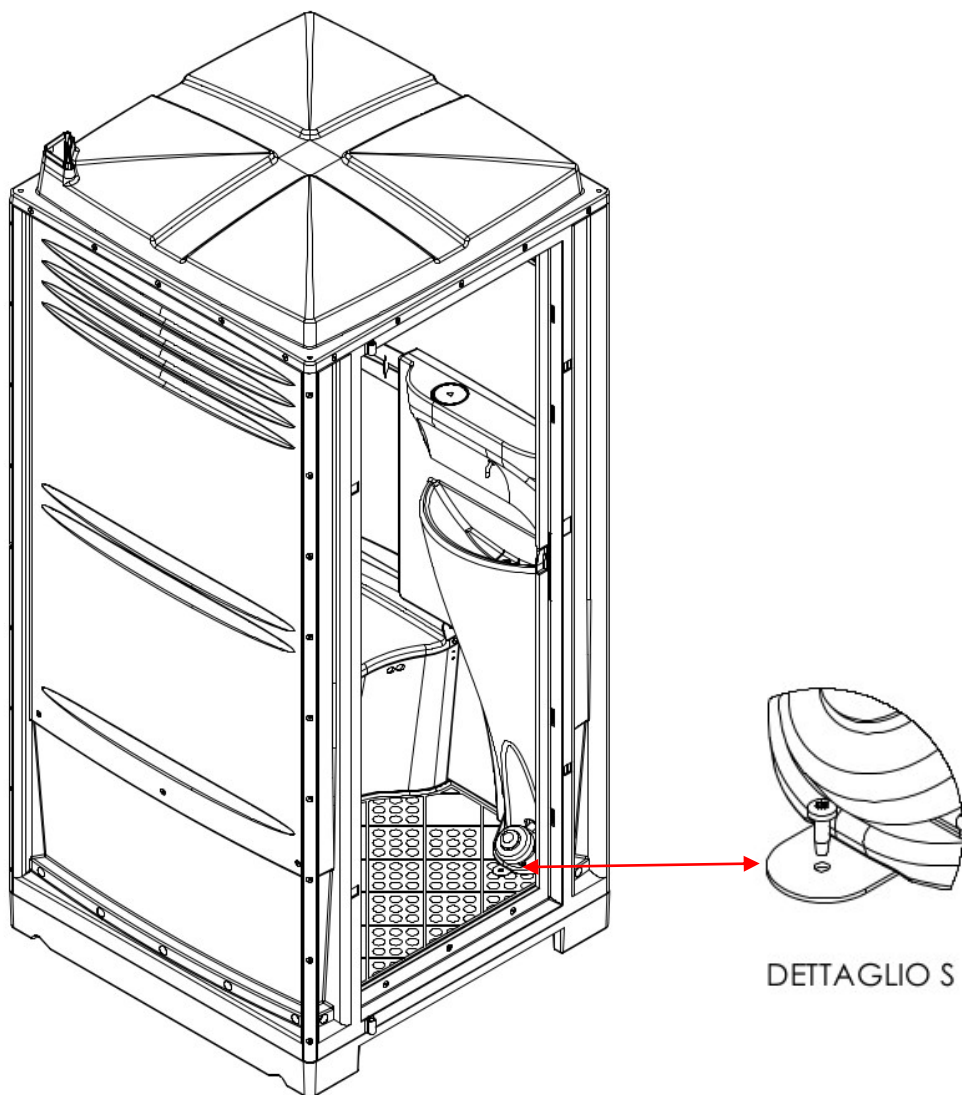

DETTAGLIO S

Insert the hand wash sink into the cabin. Check that the centering pin and the discharge pipe is correctly inserted into the hole of tank  
Fix hand wash sink at base with self-drilling screw.

# Installation 3

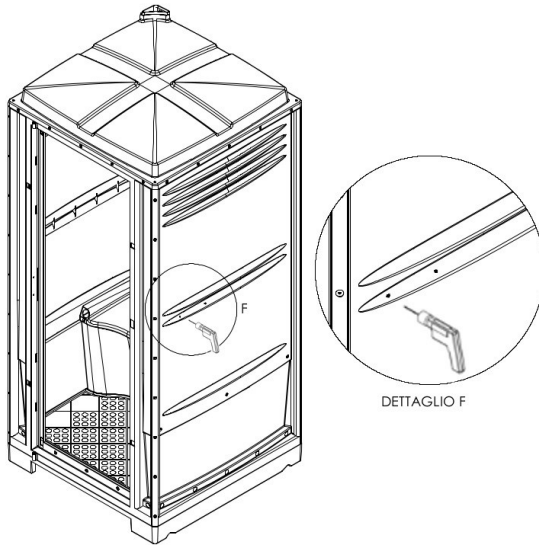

Drill 2 holes in the external wall (and into the hand wash sink inside)  
to fix hand wash sink with rivets

Drill into the low profile at centre of wall (see detail).

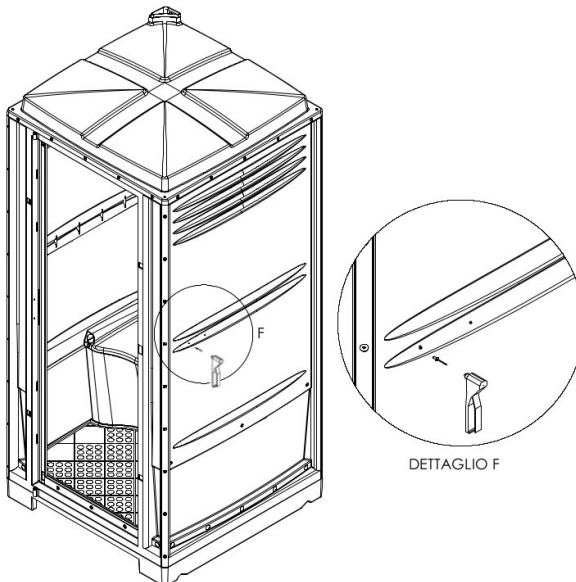

Complete the fixing of hand wash sink with 2 rivets fixing  
from external of wall.

**Arzmal**®